

1x2 PM Opto-Mechanical Switch

Feature

Unmatched Low Cost
 Low Insertion Loss
 Epoxy-Free Optical Path
 High Reliability and Stability
 High Stability

Application

Configurable Optical Networks
 Fiber Optic Instruments
 Optical Signal Routing
 Testing Instruments
 System Monitoring

Specification

Parameters	Unit	Value
Working Wavelength	nm	1530-1570
Insertion Loss	dB	≤1.0
Return Loss	dB	≥55
Extinction Ratio	dB	≥18
Cross Talk	dB	≥55
Switching Speed	ms	≤10
Durability	cycle	≥10,000,000
Repeatability	dB	≤+/-0.03
Operating Voltage	V	5
Fiber Tensile Load	N	5
Maximum Optical Power (CW)	mW	300
Operating Temperature	°C	0~70
Storage Temperature	°C	-40~85

Note: 1. Specifications are for device without connectors; Specifications may change without notice.

2. To add connectors, IL is 0.3dB higher, RL is 5dB lower, ER is 2dB Lower, Connector key is aligned to slow axis.

3. Devices for higher optical power or with other type fiber or consigned fiber are also available.

Package Dimensions

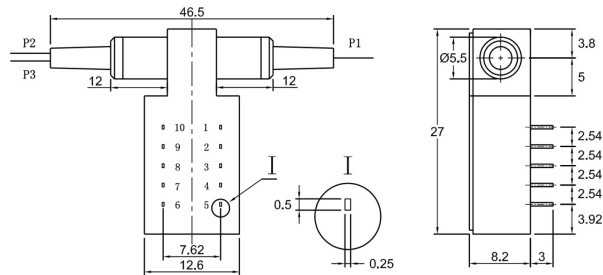

Pin configuration

LATCHING TYPE	Electrical Drive				Status Sensor			
	Pin 1	Pin 10	Pin 5	Pin 6	Pin 2-3	Pin 3-4	Pin 7-8	Pin 8-9
Path 1-2	V+	GND	NC	NC	Open	Close	Close	Open
Path 1-3	GND	V+	NC	NC	Close	Open	Open	Close
NON-LATCH -ING TYPE	Electrical Drive				Status Sensor			
	Pin 1	Pin 10	Pin 5	Pin 6	Pin 2-3	Pin 3-4	Pin 7-8	Pin 8-9
Path 1-2	NC	NC	NC	NC	Open	Close	Close	Open
Path 1-3	GND	V+	NC	NC	Close	Open	Open	Close

Ordering information

FPMS- NNNN - NXN	C	-	N	C	NN	-	CC/CCC
Center Wavelength	Configuration:	Latching:	Fiber Type	Fiber Sleeve	Fiber Length	Connector Type	
1550-1550nm	1X1- 1x1 Type 1X2- 1x2 Type	L- Latching N-Non-Latching	2- 250um Panda PM Fiber	B- Bare Fiber L- Loose Tube	10-1.0m 15-1.5m 20-2.0m	N -Without Connector FC/APC-FC/APC Connector LC/PC-LC/PC Connector	